

## Check-valves

crack-pressures down to 10mbar

- C1 Series:** operating pressure 60 bar  
end-connections up to 1"  
low-cost
- C2 Series:** operating pressure 160 bar  
end-connections up to 1 1/2"  
high flow
- C3 Series:** operating pressure 350bar  
end-connections 3/8"
- Distribution products:** operating pressures up to 690 bar  
end-connections 1/4" - 1"

Documentation:  
EN 10204-2.2 standard  
3.1 B upon request

## C-Series

end-connections: up to 2"  
Operating pressures up to 690 ba

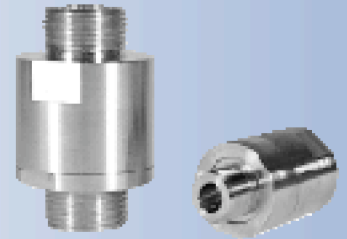

## Large variety of specials

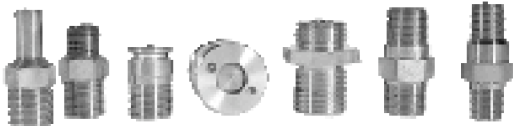

- Leak-tight  $\geq$  crack-pressure
- **Materials:**  
Brass  
St.st.  
CuAl10Ni (2.0966)  
PVDF  
Hastelloy C
- **Threads:** BSPT, BSPP, NPT
- **Seals:** Buna-N, Viton, EPR, PTFE, Chemraz
- **Operating temperature:** -70°C...+200°C
- **Media:** Gases or liquids  
(compatible with materials of construction)

### What we would like to know:

Operating pressure: \_\_\_\_\_

crack-pressure called for: \_\_\_\_\_

Media : \_\_\_\_\_

Flow: \_\_\_\_\_

Application: \_\_\_\_\_

DRUKON  
Druck-Kontrolltechnik  
GmbH  
Hauptstraße 29  
02794 Spitzkunnersdorf

Tel. 035842/2 76 30  
Fax 035842/2 76 31

e-mail: info@drukun.de