

Fillsystems, sequential

sequential filling of pressure vessels

Type BE / BF

**Operating Pressure
350 bar**

Options:
integrated shut-off valves
integrated regulating valves
integrated filter
number of vessels to specification

Documentation:
EN 10204-3.1 B

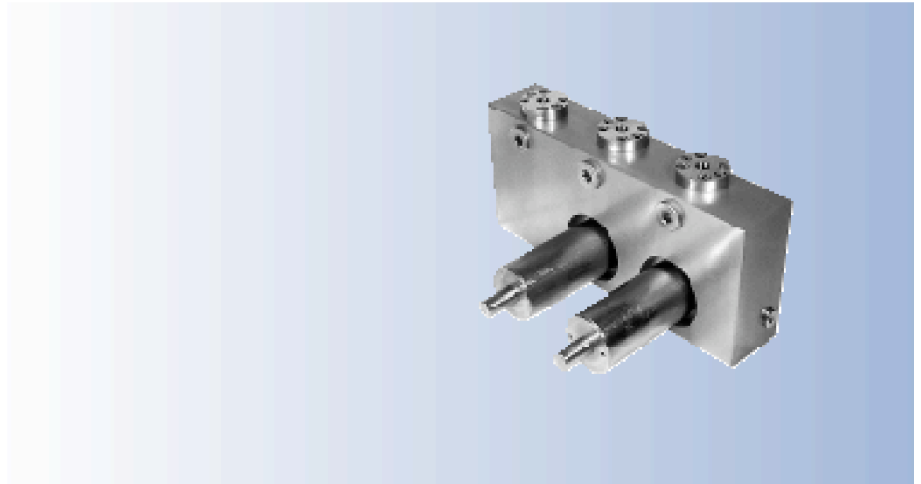

Scematic of flow:

Customized

- **Spring-loaded**
- integrated check-valves
- nominal diameter to specification
- **Material:** Aluminium, Brass, St.St.
- **Elastomeres:** Buna-N, Viton, EPR
- **Valve-seat:** PTFE, TFM, Kel-F, Peek or Torlon upon specificaton
- **Seat- \emptyset regulator:** 7.5 mm, balanced others upon request
- **Mounting:** mounting threads
- **Operating temperature:** - 20°C...+70°C
- **Medium:** Gases
(compatible with

What we would like to know:

Scematic: _____

Regulating ranges called for: _____ Temperature: _____

Medium : _____ Flow: _____

Application: _____

Note: We reccomend filtration of media at approx. 25 μ

DRUKON
Druck-Kontrolltechnik
GmbH
Hauptstraße 29
02794 Spitzkunnersdorf

Tel. 035842/2 76 30
Fax 035842/2 76 31

e-mail: info@drukón.de